

**Product:** KLUDI THERMOSTAT concealed thermostatic mixer body, pre- installation set DN 15

**Ref.:** 35156

### Product description

Thermostat concealed thermostatic mixer body  
pre-installation set  
without trim set  
in wall installation  
flow class B  
ceramic headpart 90°  
dirt-catcher sieve  
back flow preventer  
noise group I  
PA-IX 8409/IB

### Advertisement

- \* KLUDI GmbH & Co KG KLUDI concealed thermostat mixer body item no. 35156
- \*\* thermostat control element, DIN EN 1111
- \*\*\* brass, DIN EN 50930-6
- \*\*\*\* ceramic headpart 90°, DIN EN 200

concealed thermostat mixer body, manufacturer KLUDI GmbH & Co KG KLUDI concealed thermostat mixer body item no. 35156, DN 15, brass, ceramic headpart 90°, for installation depth 63 - 83 mm, type: concealed thermostat mixer body DN 15, flow class B max. 0,42 l/s, noise level DIN EN 4109 group I, report no. PA- IX 8409, without trim set, dirt catcher sieve, connectors 1/2 inch, outlets 1/2 inch, with shut-off valve, with back flow preventer, for pressure type water heater, for continuous line heater, PN 10,

### Product picture



### Dimensional drawing

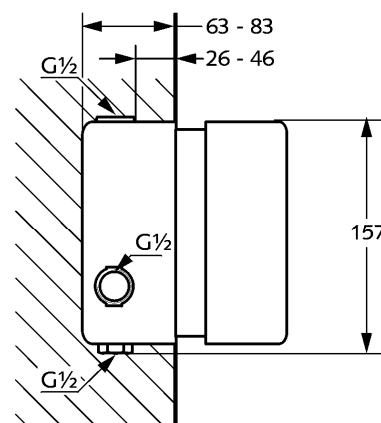

### Flow rate diagram

