

Montage: „Drehfix Multibox“ - Grundkörper

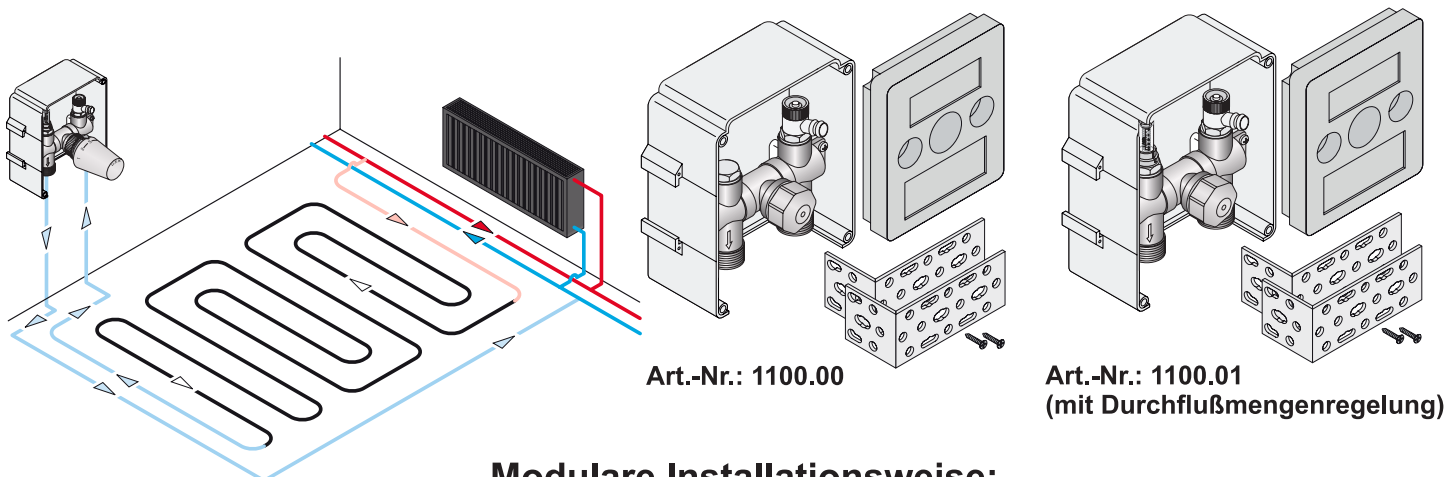

Modulare Installationsweise:

Grundkörper + Regel-Set = komplette Einzelraumregelung

VARIO DESIGN RTL-TH (gem. EnEV)



Art.-Nr.: 1141.50
(von vorne einstellbar)
Therstatkopf
mit integriertem RTL

REGELSET TOP RTL-Funktion



Art.-Nr.: 1142.90
(von vorne einstellbar)
RTL-Kopf
mit integriertem RTL

SET 3 (RTL-Funktion)



Art.-Nr.: 1142.00
(von oben einstellbar)

SET 4 (TH-Funktion)

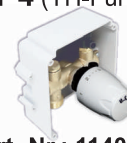

Art.-Nr.: 1140.03
(von vorne einstellbar)

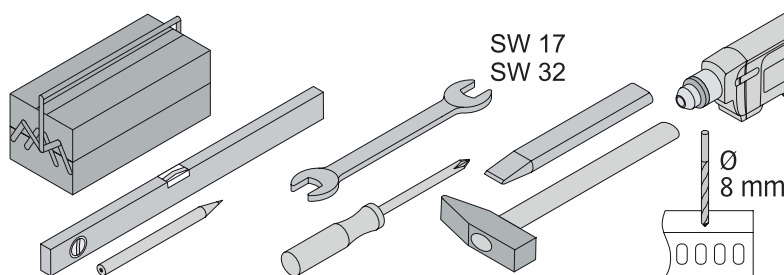

Bauseitige Beistellungen:

Eurokonus (3/4 Zoll)

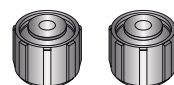

+ Anschlußmaterial

min. 2 x

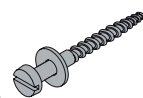

6 x 40

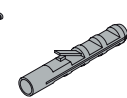

Ø 8 mm

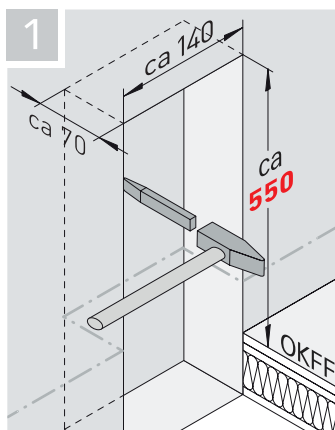

Alle Maßangaben in mm

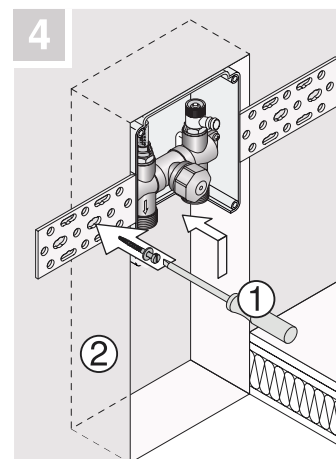
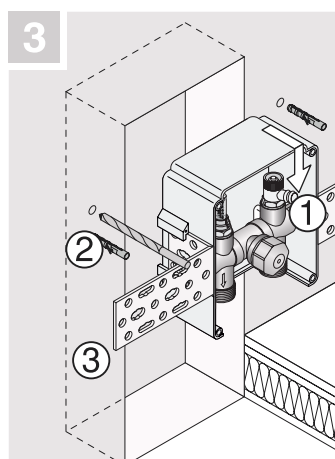
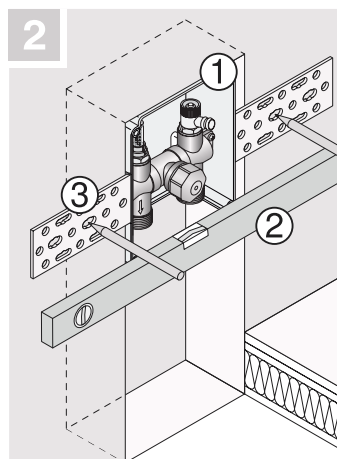

5 Einbautiefe

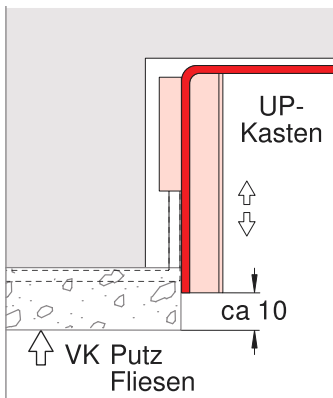

6 Arretierung

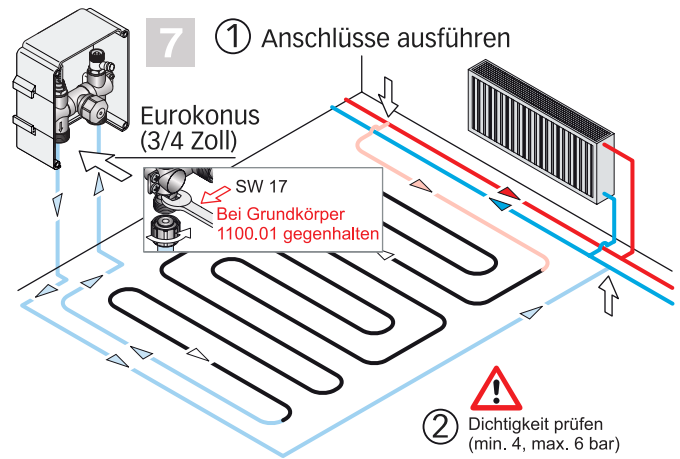
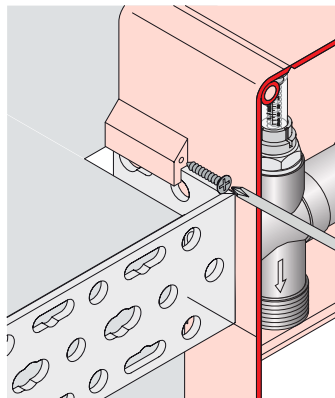

8 Bei Grundkörper 1100.01 Durchfluss einstellen

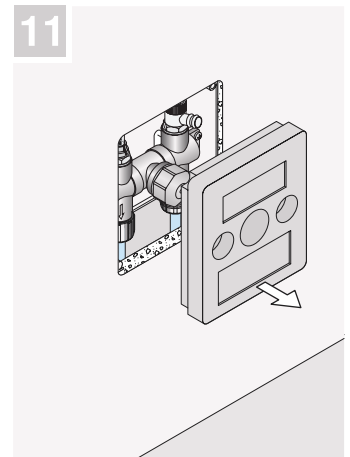
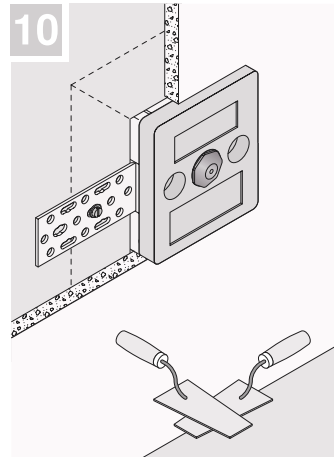
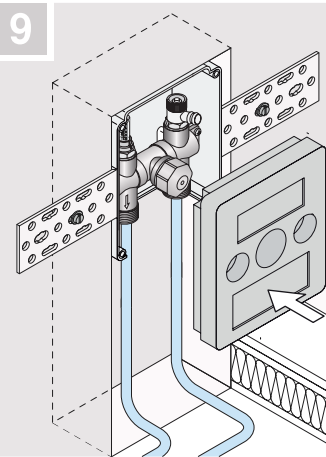
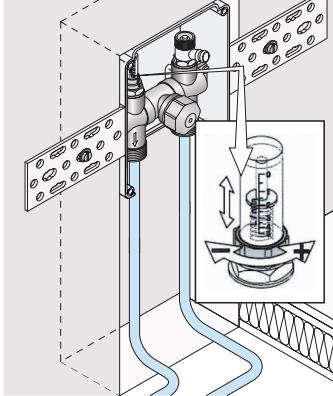

12

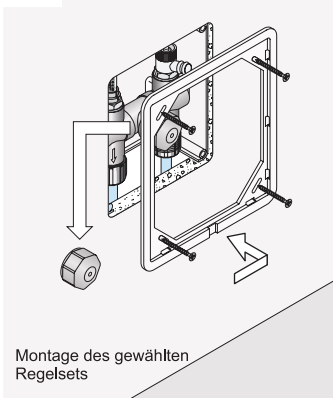

Tauschen der Flussrichtung

